

- NOTES:**
1. FOLIAGE NOT SHOWN FOR CLARITY (AND OTHER INEXPLICABLE REASONS)
 2. TREE TO BE COVERED IN ASBESTOS FREE FLOCKING

A HOLIDAY TREE NORTH ELEVATION
SCALE: 3/17"=1.0m

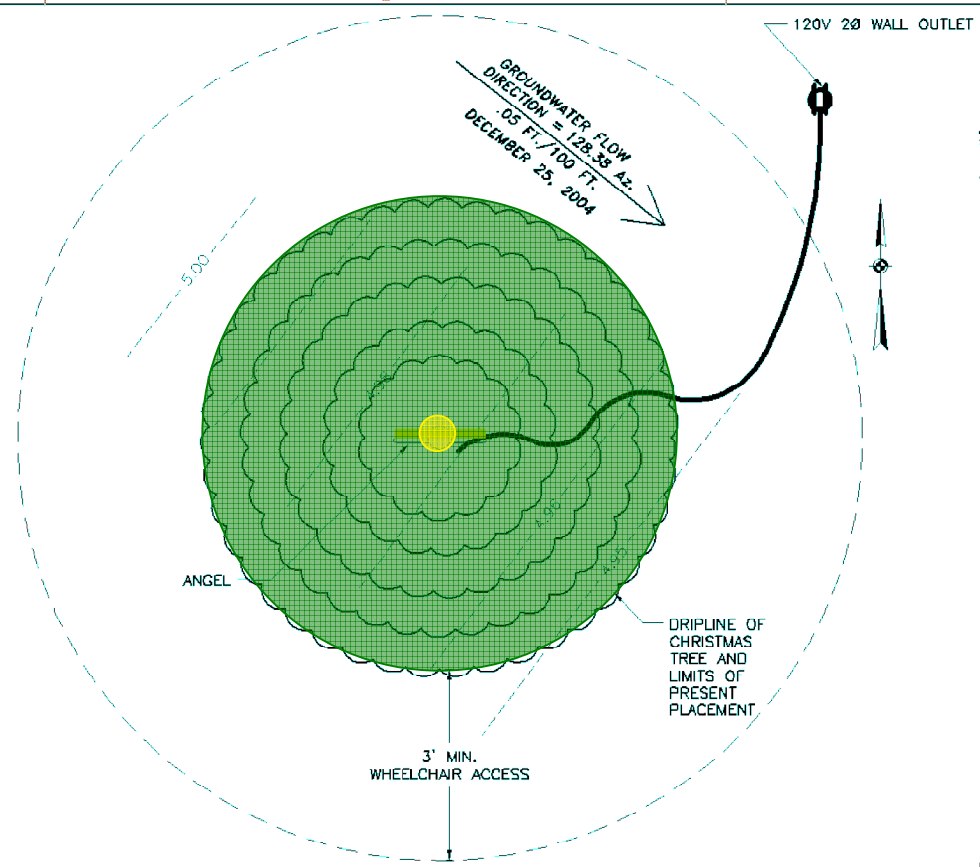

B HOLIDAY TREE PLAN
SCALE: 3/17"=1.0m

- STRUCTURAL NOTES:**
- GENERAL:**
1. ALL TREES OVER 6'-0" SHALL COMPLY WITH THE 1998 EDITION OF UBC, CBC, UMC, UPC, ALL ADA COMPLIANCY STANDARDS, AND ALL RESTRICTIONS PUT FORTH IN THE PROJECT EIR.
 2. LOADS:
WIND LOAD = [30 MPH] BASIC WIND SPEED EXPOSURE C
SEISMIC LOAD = ZONE 4 WITHIN 2 km OF SEISMIC SOURCE B FAULT
 3. THIS PROJECT REQUIRES A CLASS "B" LICENSE.
 4. CHRISTMAS TREE SPRAYED WITH FLAME RETARDANT, THEN SCENTED WITH PINE AEROSOL TO HIDE THE FOUL STENCH OF FLAME RETARDANT.
 5. EXTENSIVE SEISMIC STUDIES TO BE CARRIED OUT BY THE CONTRACTOR TO ENSURE THAT TREE IS PLACED IN A GEOLOGICALLY SECURE AREA.
 6. INSTALLATION OF THIS PROJECT DOES NOT GUARANTEE PERSONAL JOY, MERRIMENT, OR OTHER TYPICAL EMOTIONAL FEELINGS OF THE HOLIDAYS.
 7. USE OF ALCOHOLIC BEVERAGES MAY INCREASE OVERALL MERRIMENT BUT SHOULD NOT BE CONSUMED UNTIL TREE IS INSTALLED AND ELECTRICAL ITEMS PLUGGED IN.
 8. NO DUCT TAPE WITHOUT PRIOR APPROVAL BY PROFESSIONAL ELF
- METAL:**
1. ONLY 8d NAILS ARE TO BE USED
 2. ALL METAL BRACES AND CLIPS TO BE SIMPSON BRAND OR APPROVED EQUAL AND TO BE INSPECTED BY A CERTIFIED P.E. (PROFESSIONAL ELF)
- CONCRETE:**
1. IF CONCRETE IS BEING USED THEN YOU'VE DONE SOMETHING WRONG
- MITIGATION NOTES:**
1. CUT TREE SHALL BE REPLACED BY NATIVE SPECIES AT 4:1 RATIO WITHIN 50 FEET OF ORIGINAL CUT TREE.
 2. MONTHLY MONITORING REPORT TO BE SUBMITTED TO ENSURE A MIN. 50% SURVIVAL RATE BY FOLLOWING HOLIDAY.
 3. MONITORING REPORT SHALL INCLUDE PARTRIDGE SURVEY RESULTS.
 4. NO ELVES ARE TO BE HARMED DURING TREE REMOVAL, TREE CONSTRUCTION, AND TREE REHABILITATION.
 5. CONTRACTOR TO SUBMIT REINDEER EXCREMENT MANAGEMENT PLAN

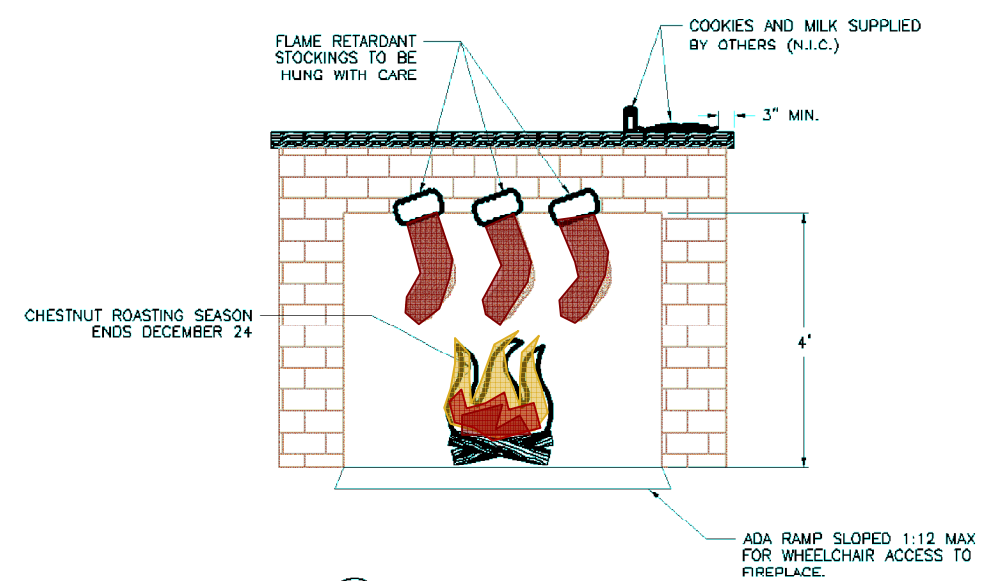

1 FIREPLACE DETAILS
SCALE: 3/17"=1.0m

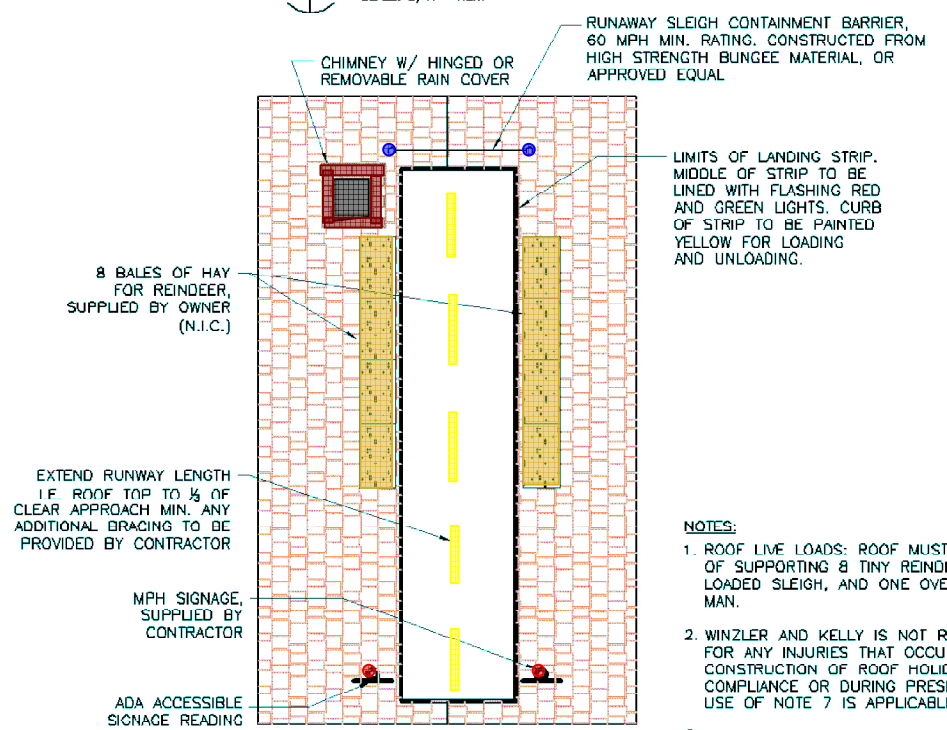

C ROOF TOP HOLIDAY COMPLIANCE PLANS
SCALE: 3/17"=1.0m

- NOTES:**
1. ROOF LIVE LOADS: ROOF MUST BE CAPABLE OF SUPPORTING 8 TINY REINDEER, ONE LOADED SLEIGH, AND ONE OVERWEIGHT MAN.
 2. WINZLER AND KELLY IS NOT RESPONSIBLE FOR ANY INJURIES THAT OCCUR DURING CONSTRUCTION OF ROOF HOLIDAY COMPLIANCE OR DURING PRESENT DELIVERY. USE OF NOTE 7 IS APPLICABLE.
 3. ROOF TOP DECORATIONS, LIGHTS, AND HOLIDAY ITEMS TO BE INSTALLED BY OWNER AND TO EXCEED NEIGHBORS DECORATIONS IN THE "SPIRIT" OF THE HOLIDAYS.

NOTE:
LOCATION OF EXISTING STRUCTURES ARE FROM THE BEST INFORMATION AVAILABLE. EXACT LOCATION AND COMPLETENESS ARE NOT GUARANTEED. ADDITIONALLY, HOLIDAY MERRIMENT TO DEPEND ON THE BEHAVIOR OF THE INDIVIDUAL. IF THE CONTRACTOR KNOWS SOMEONE TO BE NAUGHTY HE/SHE SHALL NOTIFY THE NEAREST ELF A MIN. OF 48 HOURS PRIOR TO ANY GIFT GIVING OR MERRIMENT.

97.2% SUBMITTAL
PLEASE RETURN WITH COMMENTS NO LATER THAN MIDNIGHT, DECEMBER 24

NO.	DATE	DESCRIPTION	REVISIONS

WINZLER & KELLY ENGINEERS CONSULTING
PH (707) 443-8328
FAX (707) 444-8330
633 THIRD STREET
EUREKA, CA 95501-0417

J.C. INC. CORPORATE CASH COW IMPROVEMENT PLAN FESTIVE

HAPPY HOLIDAY PLANS, SPECS AND ELEVATIONS

JOB NUMBER: _____
SHEET 1 OF 1

1